

---

# DRIVE-CONTROL COMPONENTS

## CONTENTS

FRONT SUSPENSION .....	2	WHEEL AND TIRES .....	4
REAR SUSPENSION .....	3	SERVICE BRAKES .....	5



## FRONT SUSPENSION

The front suspension has been revised as follows:

- In order to enhance the driving stability, the front roll center has been lowered by changing the installation method of the ball joint between the knuckle and the lower arm.
- The knuckle has been replaced by one manufactured by forging. It has also been revised in shape because of the change in the ball joint.

<EVOLUTION-VI>

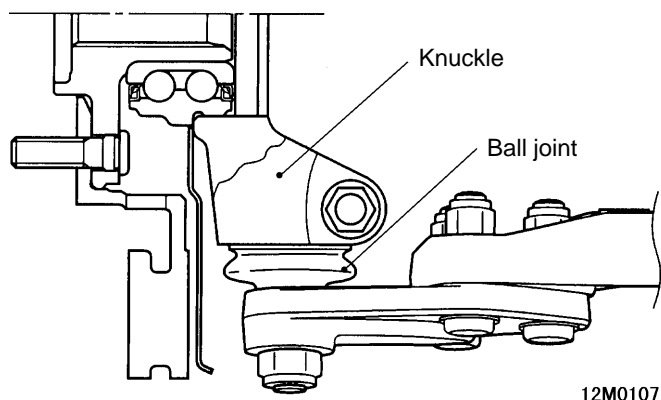

<Base vehicle (EVOLUTION-V)>

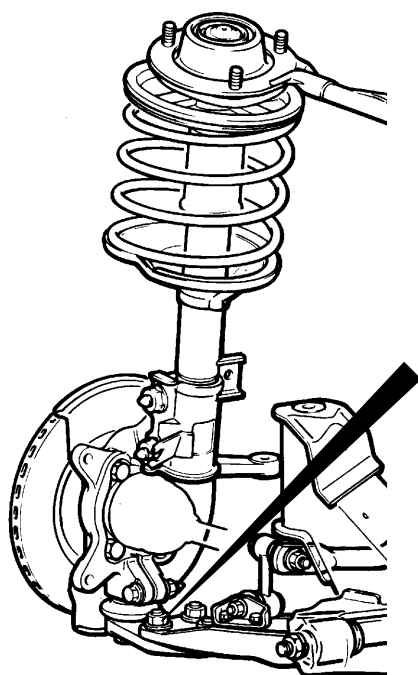
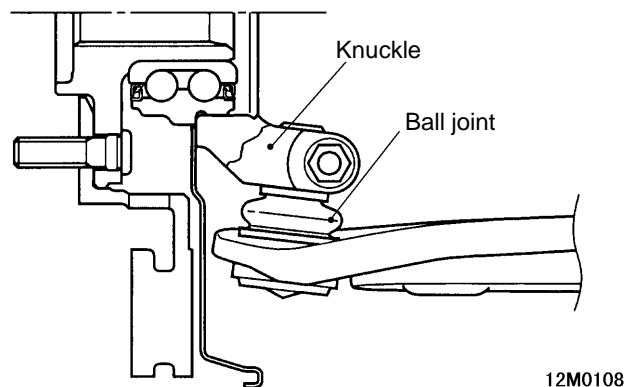

## REAR SUSPENSION

The rear suspension has been revised as follows:

- The lower arms, trailing arms and toe control arms have been replaced by aluminum forged ones for lighter weight.
- In order to improve the drive stability, the bushing of the lower arm-to-crossmember joint has been replaced by one of pillow ball type.
- The shock absorber stroke (tire stroke) has been increased.

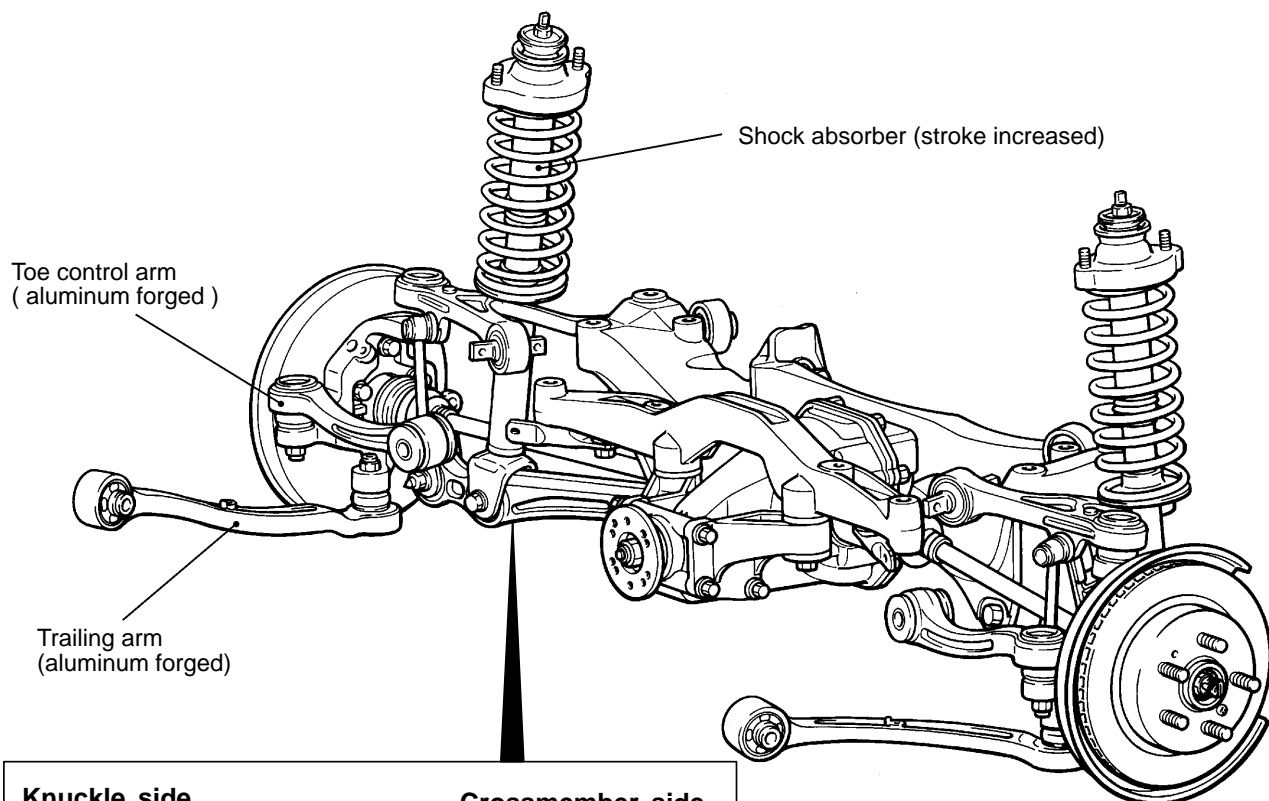

A12M0113

Knuckle side

Crossmember side

Lower arm (aluminum forged)

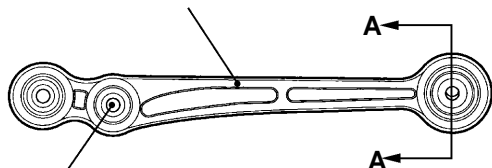

Shock absorber connection

Section A-A

A12M0115

&lt;EVOLUTION-VI&gt;

Pillow ball bushing

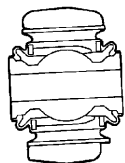

12M0106

&lt;Base vehicle (EVOLUTION-V)&gt;

Rubber bushing

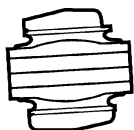

A12M0070

## WHEELS AND TIRES

The newly designed 17-inch aluminum wheel is the standard wheel for GSR. It is also available for RS as a maker-option.

<EVOLUTION-VI>

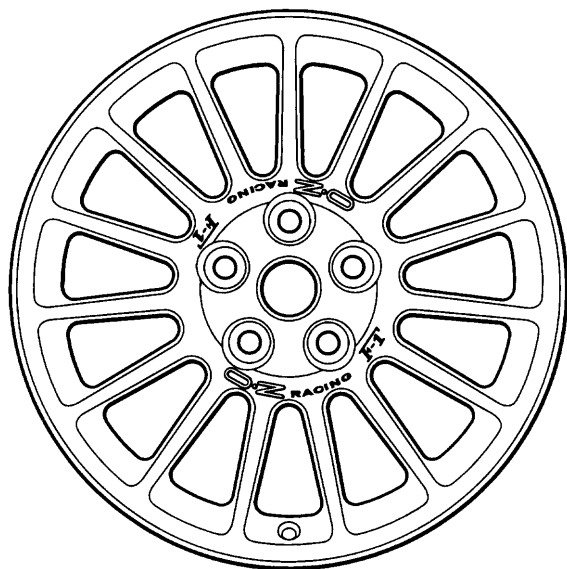

11M0089

<Base vehicle (EVOLUTION-V)>



11M0088

## SERVICE BRAKES

The Brembo front and rear brakes have been revised as follows:

- The clips for securing the pins have been eliminated.
- With elimination of the clips, each pin had a bushing added and the clip mounting hole eliminated.
- Two shims have been added.

<Front>

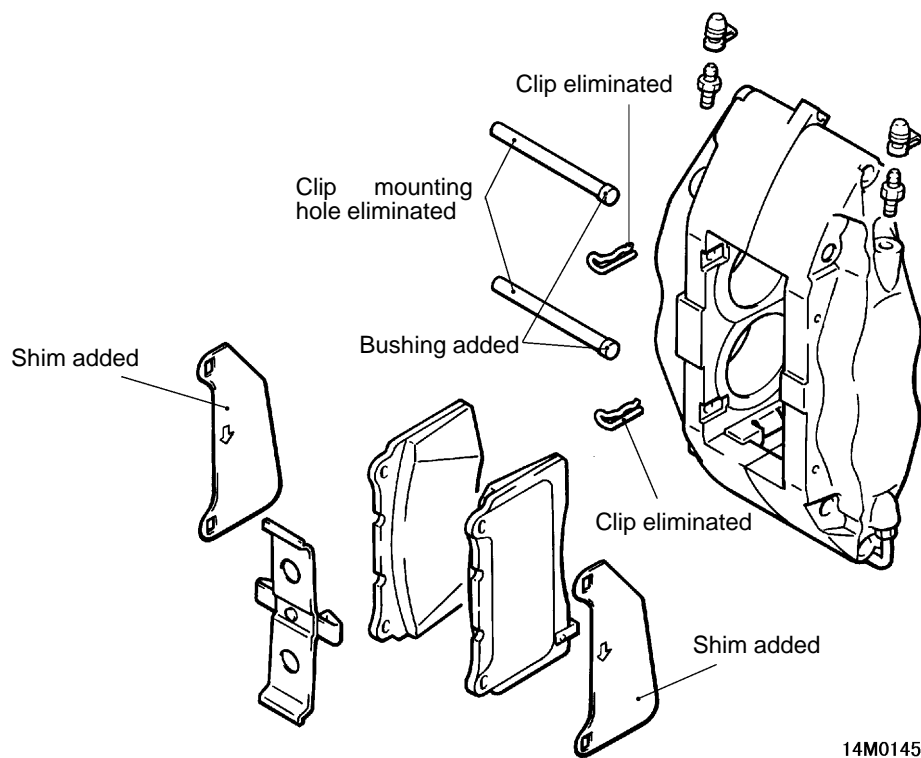

<Rear>

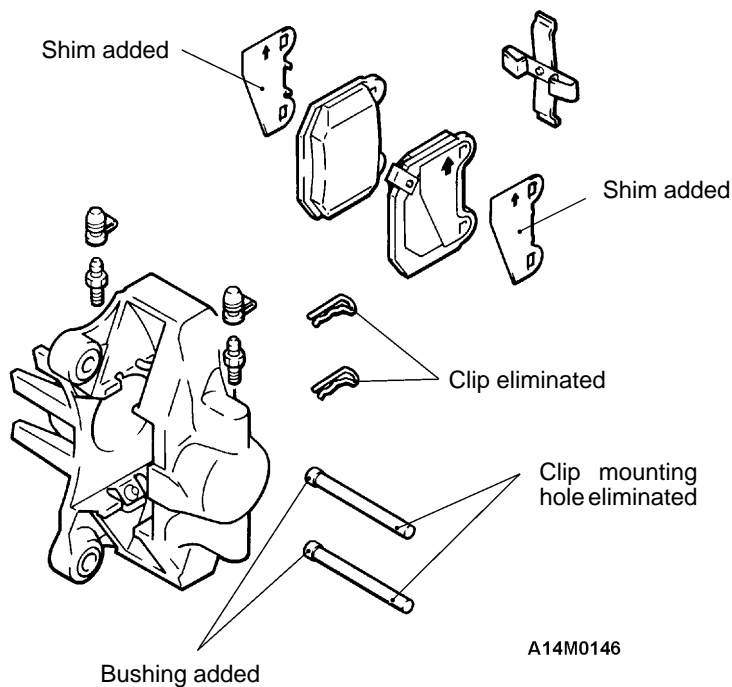

---

## NOTES